



MODEL

598



INDUSTRY LEADING  
COMMERCIAL & INDUSTRIAL SOLUTIONS

# Light-Duty Thermacore® Steel Door System

## MODEL 598



Installation and Service: Overhead Door Company of Twin Falls

### Standard Features At a Glance

Panel thickness	1" (25.4 mm)
R-value	9.31 (1.64 W/Msq)
U-value	.107 (.608 Msq/W)
Thermal break	Hot melt
Exterior steel	.012" (.3 mm) galv.
Exterior surface	Ribbed, textured
Standard Springs	10,000 cycle
Std. maximum width	16'2" (4928 mm)
Std. maximum height	14'1" (4293 mm)
Exterior color	White
Interior color	White
Limited warranty	8-year delamination 1-year door 3-year/20,000 cycle door and operator system

### Options

- Thermal glazing
- High cycle springs
- Wind load options
- Electric operator
- Chain hoist
- Posi-Tension® drums
- Safety bottom fixture
- Flexible jamb, header seal

## A Solid Choice That Saves Energy

The Thermacore® Model 598 is an exceptionally well-built door that provides a higher level of thermal protection than standard insulated doors. The Thermacore® CFC-free, fully encapsulated, foamed-in place panel maintains R-value performance year round– and year in and year out. Fabricated using Overhead Door Corporation's proprietary, computer-controlled manufacturing process, Model 598 adheres to strict product tolerances and quality standards – making it a solid choice for projects where economy and energy efficiency are equally important.

### Strong, Lightweight, Attractive and Durable.

The Thermacore® 598 features .012" (.31 mm) roll-formed, hot-dipped galvanized steel exterior panels. Two coats of white baked-on, polyester paint on the interior and exterior provide a handsome finish that will last for years. Our 8-year warranty against delamination means that we'll stand behind the quality of our doors at the outset and for the long haul.

### Superior Field Serviceability.

Thermacore® has a special internal construction which allows hinges to be placed anywhere along the panel's length, permitting customization on the job site – for fast and precise installation, repair or retrofit.

### Engineered for Higher Thermal Efficiency.

The Thermacore® product line's unique manufacturing process provides a CFC-free, fully encapsulated, foamed-in place panel which maintains R-value performance. Overlapping and tight-fitting, heavy-duty fixtures and "hot melt" thermal breaks minimize air infiltration and provide one of the highest thermal efficiency ratings in the industry.





# Pay and Dollars

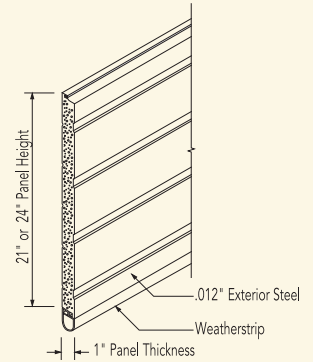

Overhead Door Corporation's line of Thermacore® steel-polyurethane-steel sandwich panel construction is lightweight, incredibly strong and exceptionally efficient – reflecting a premium level of thermal performance.

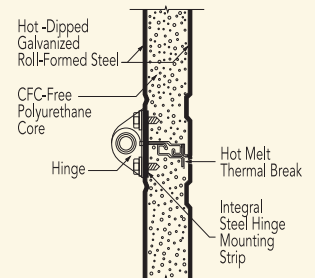

Installation and Service: Overhead Door Company of Albany

### More Options for Enhanced Versatility.

The Thermacore® 598 is available in sizes up to 16'2" (4928 mm) wide and 14'1" (4293 mm) high. A full line of electric operators ensure precise and trouble-free motor operation in a variety of mounting options (side, center or trolley). Available options include thermal glazing, high-cycle springs, header and jamb seals.

## The Original, Innovative Choice for Unequaled Quality and Service

Overhead Door Corporation pioneered the upward-acting door industry, inventing the first upward-acting door in 1921 and the first electric door operator in 1926. Today, we continue to be the industry leader through the strength of our product innovation, superior craftsmanship and outstanding customer support, underscoring a legacy of quality, expertise and integrity. That's why design and construction professionals specify Overhead Door Corporation products more often than any other brand.

The Overhead Door Red Ribbon is a mark of quality that also reflects the pride we take in the people who support our products. Our family of over 400 Overhead Door Distributors across the country not only share our name and logo, but also our commitment to excellence. Your Overhead Door Distributor will work with you in a consultative role to ensure that product selections achieve your design and application requirements — in addition to offering expert installation, professional field service and ongoing maintenance. From project design and manufacturing to installation and service, the Overhead Door Red Ribbon is your guarantee of genuine quality and turnkey service excellence.

**Together with our distributors, we offer comprehensive technical information and resource materials to support your project, including:**

- Architectural Design Manual – a comprehensive guide to selecting, specifying and detailing all commercial and industrial Overhead Door products can be found at [www.OverheadDoor.com/ADM/base.html](http://www.OverheadDoor.com/ADM/base.html)
- Operation & Maintenance Manual – detailed product information, customized for your project, to ensure reliable, long-life door system operation
- Custom application and technical assistance through ordering plants' customer service and technical services respectively
- Visit our Architect's Corner at [www.OverheadDoor.com](http://www.OverheadDoor.com)



Advanced Rolling Steel Door  
RapidSlat®



Thermacore® Sectional Doors



Rolling & Side Folding  
Security Grilles & Closures



Rolling Service Doors



Commercial Operators

Today, Overhead Door Corporation – along with our Horton Automatics division, for automated pedestrian entrances – is recognized as the leading, single-source manufacturer of integrated door and operator systems for commercial, industrial and residential applications. With multiple manufacturing locations throughout the United States, a state-of-the-art TREQ (Testing, Reliability, Engineering, and Quality) Center for design and engineering, and a national network of authorized Overhead Door Distributors, our capabilities are leading-edge and our field service and technical support second to none. Built best and backed best, Overhead Door is the industry's leading choice for quality that shows and lasts.

**To talk with the Overhead Door Distributor nearest you, call 1-800-929-DOOR.**

### Overhead Door Corporation

2501 S. State Hwy. 121 Bus., Suite 200

Lewisville, Texas 75067

1-800-929-DOOR

[www.OverheadDoor.com](http://www.OverheadDoor.com)



INDUSTRY LEADING  
COMMERCIAL & INDUSTRIAL SOLUTIONS

The Overhead Door Corporation family of quality commercial and industrial products includes:



A part of Sanwa Holdings Corporation